

REVISIONS		
DEC. 1974	R.M. SCHULZ	10597
JUNE 1976	A.F. POSTEL P.E. & L.S.	
DEC. 1982	D.H. YORRANIS P.L.S.	27479
AUG. 1988	D.W. KORTZE P.L.S.	30083
DEC. 1989	D.W. KORTZE P.L.S.	30083
JAN. 2002	T.T. CRADER P.L.S.	21782
01-31-05	RICHARD A. MORALLE, P.L.S.	6B25863
11-30-05	"	"
04-30-07	"	"
06-30-10	"	"
05-31-16	"	"

" SANDY HOOK BAY "

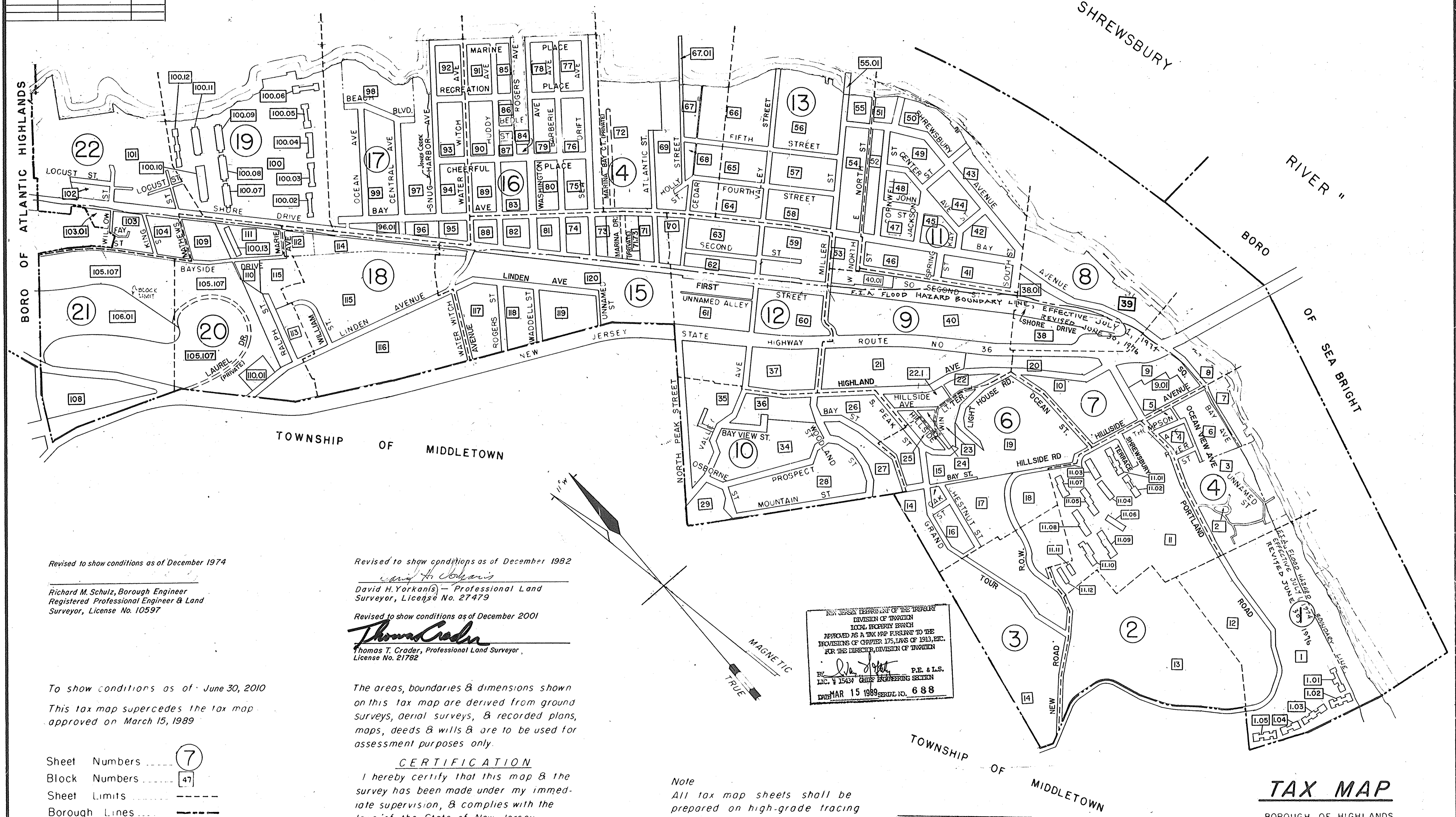

Revised to show conditions as of December 1974

Richard M. Schulz, Borough Engineer  
Registered Professional Engineer & Land Surveyor, License No. 10597

Revised to show conditions as of December 1982

David H. Yorrakis - Professional Land Surveyor, License No. 27479

Revised to show conditions as of December 2001

Thomas T. Crader, Professional Land Surveyor, License No. 21782

To show conditions as of June 30, 2010

This tax map supercedes the tax map approved on March 15, 1989

Sheet Numbers ..... 7

Block Numbers ..... 47

Sheet Limits ..... - - - - -

Borough Lines ..... - - - - -

Block Limits ..... - - - - -

I hereby certify that this map has been revised under my immediate supervision, and complies with the laws of the state of New Jersey.

Dennis W. Kortze, Professional Land Surveyor, license No. 30083

The areas, boundaries & dimensions shown on this tax map are derived from ground surveys, aerial surveys, & recorded plans, maps, deeds & wills & are to be used for assessment purposes only.

**CERTIFICATION**

I hereby certify that this map & the survey has been made under my immediate supervision, & complies with the laws of the State of New Jersey.

Frederick M. Moller  
Licensed Land Surveyor  
95 First Avenue  
Atlantic Highlands, N.J.

NEW JERSEY DEPARTMENT OF THE TREASURY  
DIVISION OF TAXATION  
LOCAL PROPERTY BRANCH  
APPROVED AS A TAX MAP PURSUANT TO THE PROVISIONS OF CHAPTER 175, LAWS OF 1913, ETC. FOR THE DIRECTOR, DIVISION OF TAXATION

BY: [Signature] P.E. & L.S.  
L.C. # 15434 CIVIL ENGINEERING SECTION  
DATE: MAR 15 1989 SERIAL NO. 688

Note  
All tax map sheets shall be prepared on high-grade tracing cloth, film base material, or polyester type plastic material.

Note  
Due to space constraints, the designation Boro and Borough have been used to designate the BOROUGH OF HIGHLANDS.

NEW JERSEY DEPARTMENT OF THE TREASURY  
DIVISION OF TAXATION  
PUBLIC UTILITY TAX BUREAU  
APPROVED AS A TAX MAP PURSUANT TO THE PROVISIONS OF CHAPTER 175, LAWS OF 1913, ETC. FOR THE DIRECTOR, DIVISION OF TAXATION

BY: [Signature] P.E. & L.S.  
DATE: DEC 2 1988 SERIAL NO. 464

REVISED TO SHOW CONDITIONS AS OF MAY 31, 2016

Richard A. Moralle, P.E., P.L.S. 6B25863

SCALE 1"=300'

DATE OCT, 1968  
REV. MAY 31, 2016

Frederick M. Moller  
Licensed Land Surveyor No 5610  
95 First Avenue, Atlantic Highlands, New Jersey

TAX MAP

BOROUGH OF HIGHLANDS  
MONMOUTH COUNTY, N.J.