

SHEET 1 SHEET 2 SHEET 3 SHEET 4 SHEET 5 SHEET 6 SHEET 7 SHEET 8

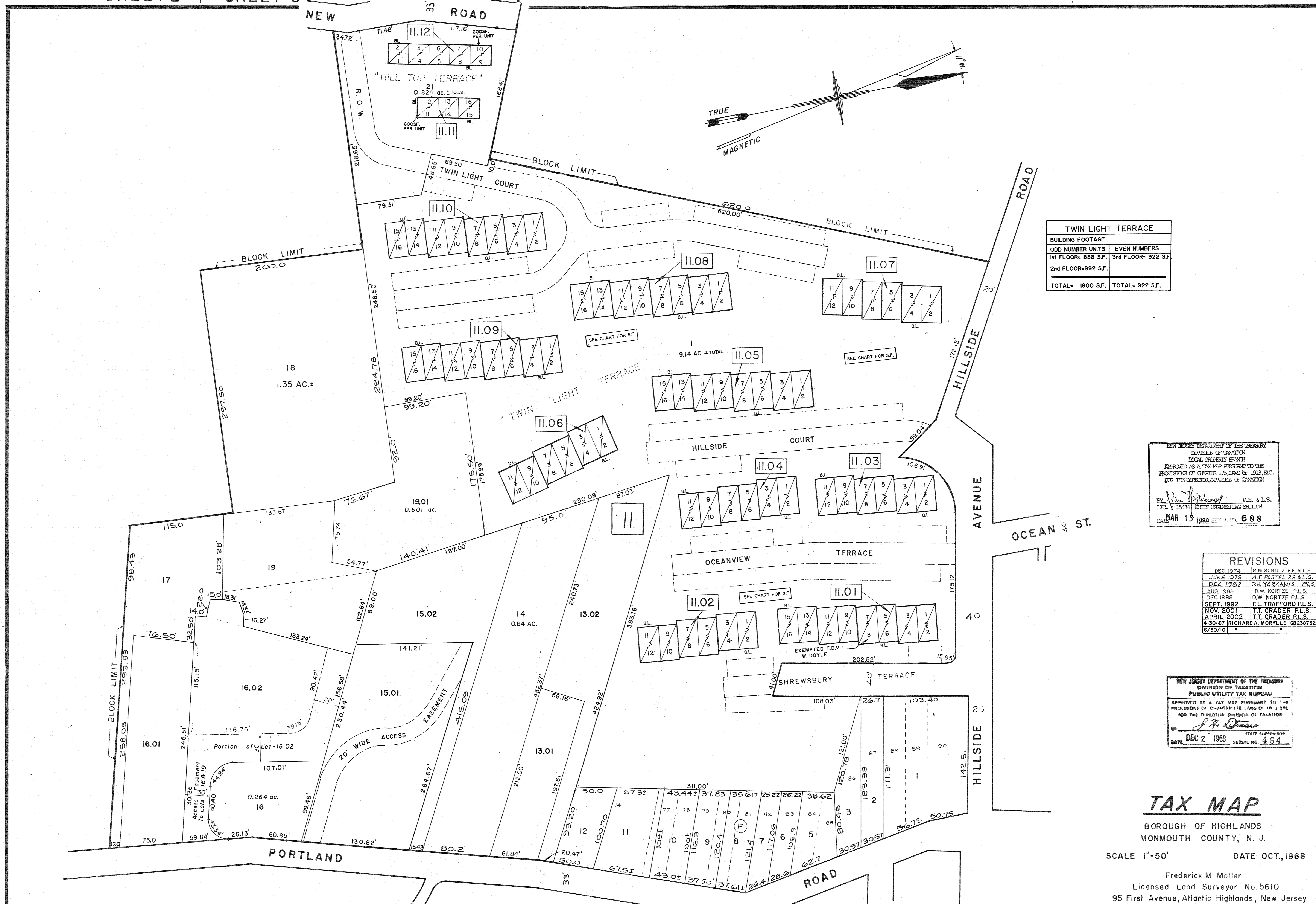

TWIN LIGHT TERRACE	
BUILDING FOOTAGE	
ODD NUMBER UNITS	EVEN NUMBERS
1st FLOOR= 888 S.F.	3rd FLOOR= 922 S.F.
2nd FLOOR= 992 S.F.	
TOTAL= 1800 S.F.	TOTAL= 922 S.F.

NEW JERSEY DEPARTMENT OF THE TREASURY
 DIVISION OF TAXATION
 LOCAL PROPERTY TAXES
 APPROVED AS A TAX MAP PURSUANT TO THE
 PROVISIONS OF CHAPTER 175, LAWS OF 1913, ETC.
 FOR THE DIRECTOR, DIVISION OF TAXATION

[Signature] P.E. & L.S.
 INC. # 15474 CIVIL ENGINEERING SECTION
 DATE: MAR 15 1988 SERIAL NO. 688

REVISIONS	
DEC. 1974	R.M. SCHULZ P.E. & L.S.
JUNE 1976	A.F. POSTEL P.E. & L.S.
DEC. 1982	D.H. YORKANIS P.L.S.
AUG. 1988	D.W. KORTZE P.L.S.
DEC. 1988	D.W. KORTZE P.L.S.
SEPT. 1992	F.L. TRAFFORD P.L.S.
NOV. 2001	T.T. CRADER P.L.S.
APRIL 2002	T.T. CRADER P.L.S.
4-30-07	RICHARD A. MORALLE 68238732
6/30/10	

NEW JERSEY DEPARTMENT OF THE TREASURY
 DIVISION OF TAXATION
 PUBLIC UTILITY TAX BUREAU
 APPROVED AS A TAX MAP PURSUANT TO THE
 PROVISIONS OF CHAPTER 175, LAWS OF 1913, ETC.
 FOR THE DIRECTOR, DIVISION OF TAXATION

[Signature] STATE SUPERVISOR
 DATE: DEC 2 1988 SERIAL NO. 464

TAX MAP

BOROUGH OF HIGHLANDS
MONMOUTH COUNTY, N. J.

SCALE: 1"=50' DATE: OCT., 1968

Frederick M. Moller
Licensed Land Surveyor No. 5610
95 First Avenue, Atlantic Highlands, New Jersey