

REVISIONS	
DATE	NAME
DEC. 1974	R.M. SHULTZ, P.E. & L.S.
JUNE. 1976	A.F. POSTEL, P.E. & L.S.
DEC. 1982	D.H. YORKANS, P.L.S.
AUG. 1988	D.W. KORTZE, P.L.S.
DEC. 1988	D.W. KORTZE, P.L.S.
DEC. 2001	T. CRADER, P.L.S. LIC.#21782
APR. 2002	T. CRADER, P.L.S. LIC.#21782
06-30-10	R.A. MORALLE, P.L.S. GB25863

SHEET 22

SHEET 20

NOTE:
ALL PROPERTIES THAT APPEAR ON THIS TAX MAP SHEET ARE SITUATED IN THE F.I.A. FLOOD HAZARD ZONE EFFECTIVE JULY 1, 1974. (REV. JUNE 30, 1976)

BAYVIEW CONDOMINIUM	
Unit Number	Unit Square Footage
22, 28, 29, 34, 35,	
40, 70, 76, 77, 82,	
83, 88, 96, 104, 105,	956 S.F.
112, 113, 120, 126,	
132, 133, 136, 139,	
144	
17, 23, 65, 71, 89,	820 S.F.
97, 121, 127	
18-21, 24-27, 30-33,	
36-39, 42-45, 48-51,	
54-57, 60-63, 66-69,	
72-75, 78-81, 84-87,	
90-93, 96-103, 106-111,	
114-119, 122-125, 128-131,	805 S.F.
143-137, 140-143	
all inclusive	
41, 46, 47, 52, 53,	815 S.F.
58, 59, 64	
2-7, 10-15	824 S.F.
all inclusive	
1, 8, 9, 16	875 S.F.
146-151, 154-159	1,007 S.F.
all inclusive	
145, 152, 153, 160	1,022 S.F.

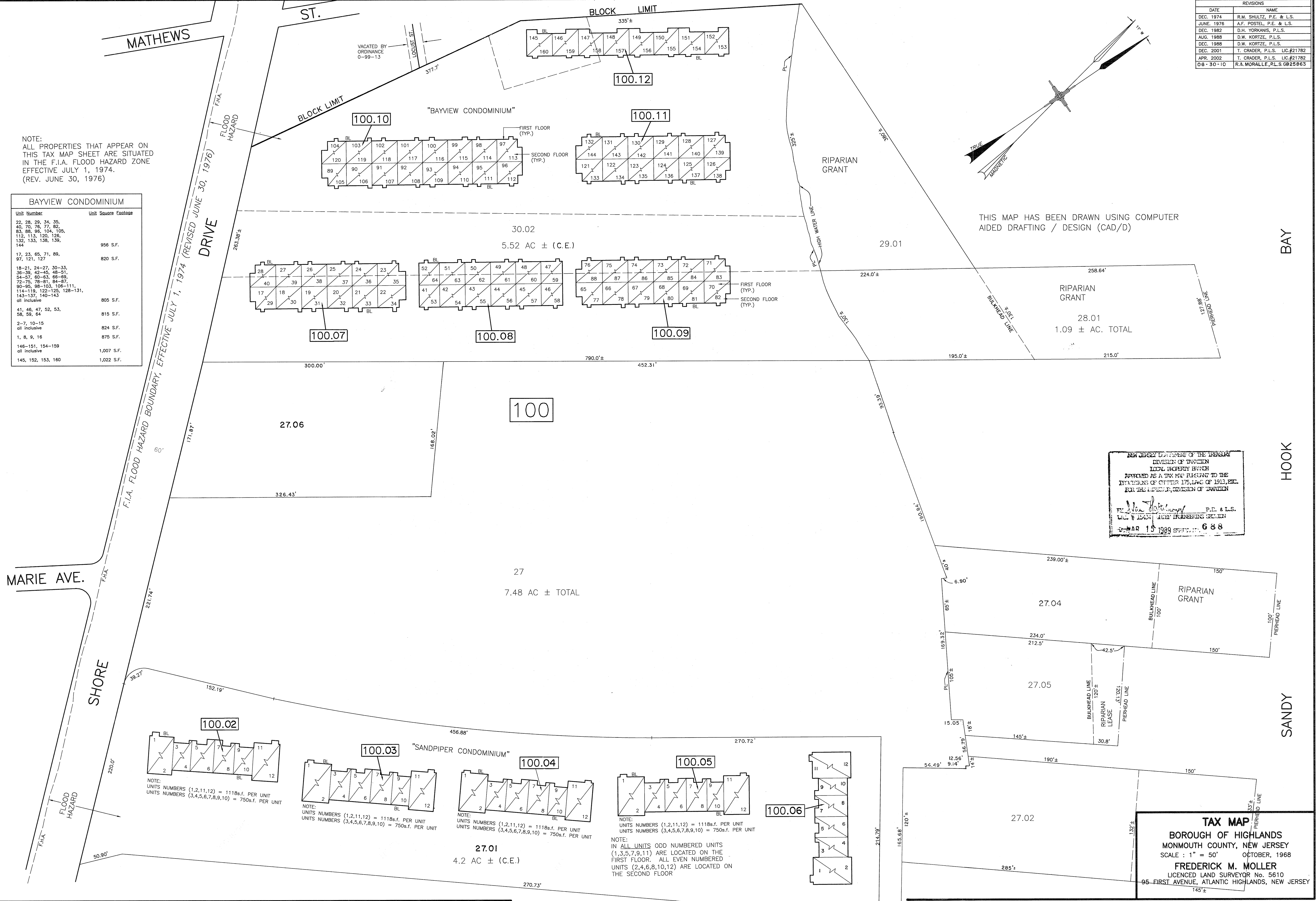

NEW JERSEY DEPARTMENT OF THE TREASURY
DIVISION OF TAXATION
LOCAL HIGHWAY BOUNDARY
APPROVED AS A TAX MAP PURSUANT TO THE
PROVISIONS OF CHAPTER 175, LAW OF 1913, ETC.
FOR THE TOWNSHIP OF HIGHLANDS, DIVISION OF TAXATION
T. M. Moralle P.E. & L.S.
MAY 15 1989 SURV. 688

TAX MAP
BOROUGH OF HIGHLANDS
MONMOUTH COUNTY, NEW JERSEY
SCALE: 1" = 50' OCTOBER, 1968
FREDERICK M. MOLLER
LICENCED LAND SURVEYOR No. 5610
95 FIRST AVENUE, ATLANTIC HIGHLANDS, NEW JERSEY
145'